



AI Fever Screening System

Product Manual

LinkSprite
2020

1、 Description of product appearance and wiring

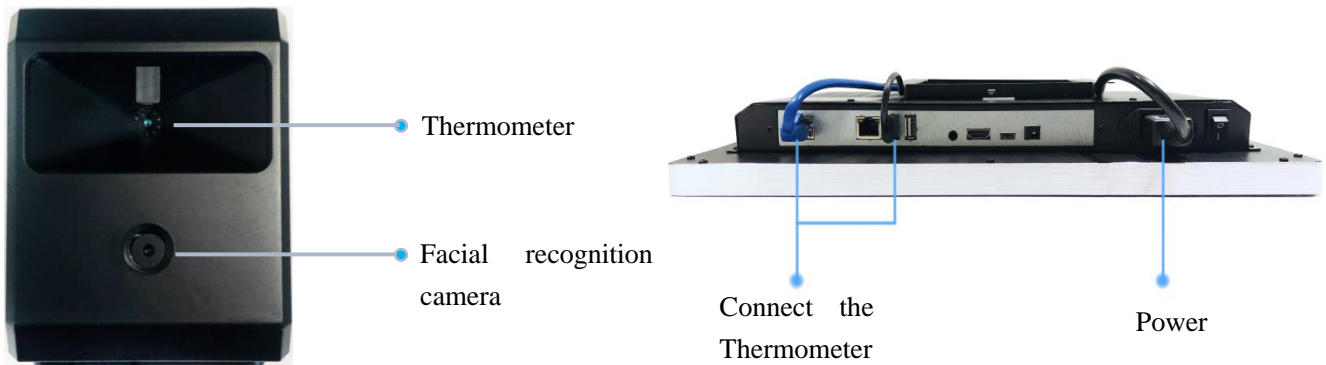





2、 Features

- ① Face recognition + forehead temperature measurement + mega data
- ② Non-contact temperature measurement
- ③ Single or multiple temperature measurement mode
- ④ Support mask-on temperature measurement
- ⑤ Built-in black body, easy to install and use

Accuracy	$\leq \pm 0.3 \text{ }^{\circ}\text{C}$ (target temperature: $32 \text{ }^{\circ}\text{C} \sim 42 \text{ }^{\circ}\text{C}$)
Measuring distance	1 ~ 2 meters, best 1 meter
Operating temperature	$16^{\circ}\text{C} \sim 32^{\circ}\text{C}$
storage temperature	$-20^{\circ}\text{C} \sim 60^{\circ}\text{C}$

Precautions

Item	Description	
	Avoid sunlight	
	Avoid strong back-lighting	

	Environment temp not below 15°C	
	Do not cover forehead	

3、 Product Composition

Model	Description	Photo
AI-001	Integrate Android Sever	
AI-002	AI Detector	
AI-003	Package	
Optional		
AI-004	TTA-AI Bracket	

4、 Installation – on a rack

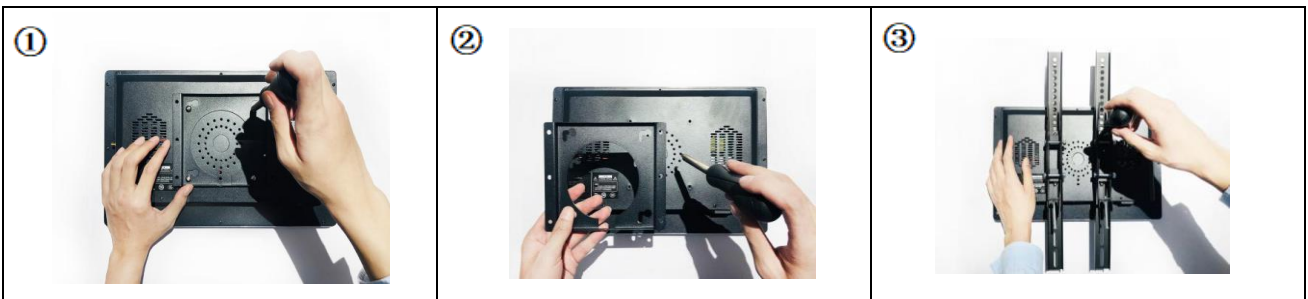



5、 Installation – on the wall

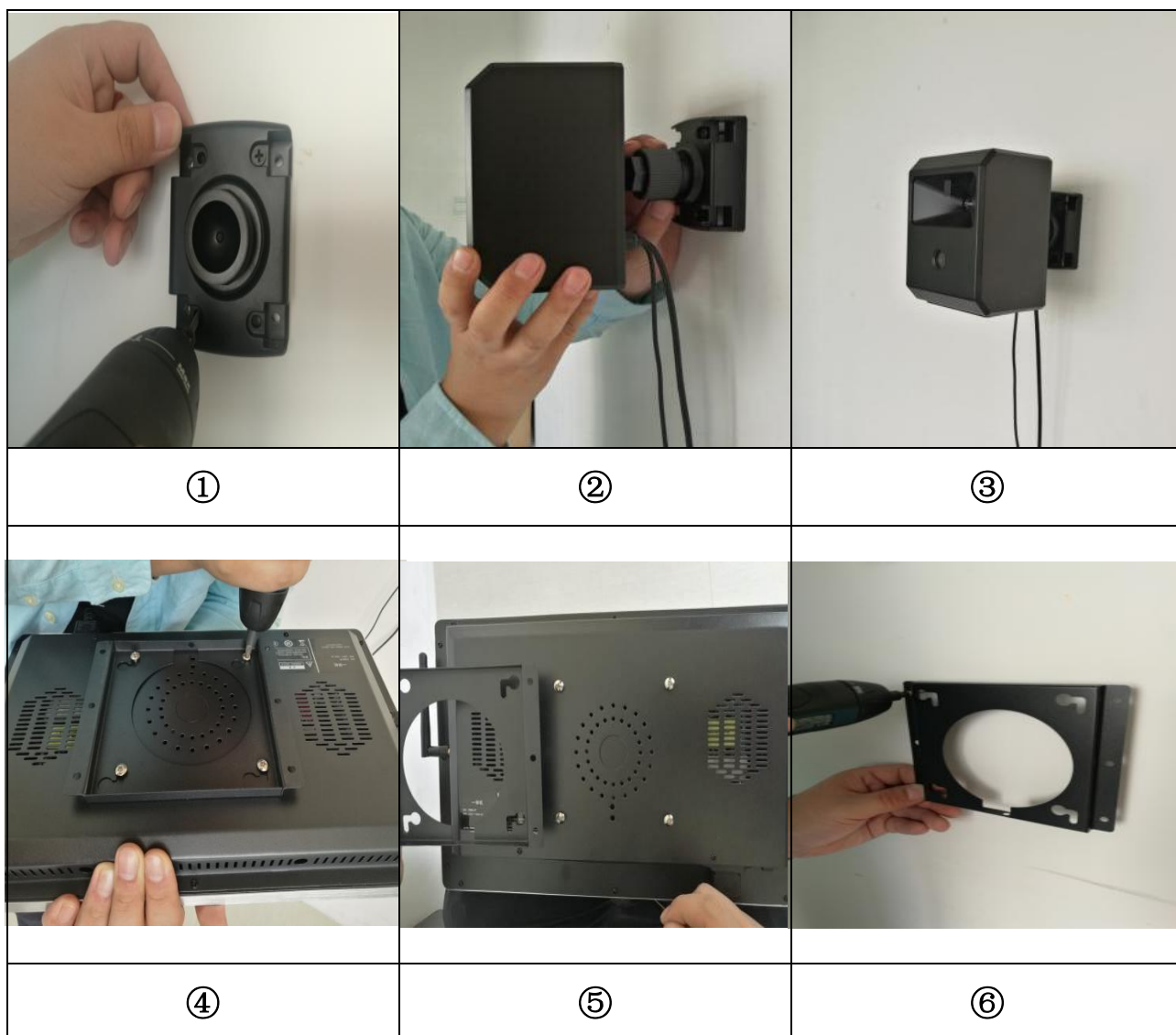

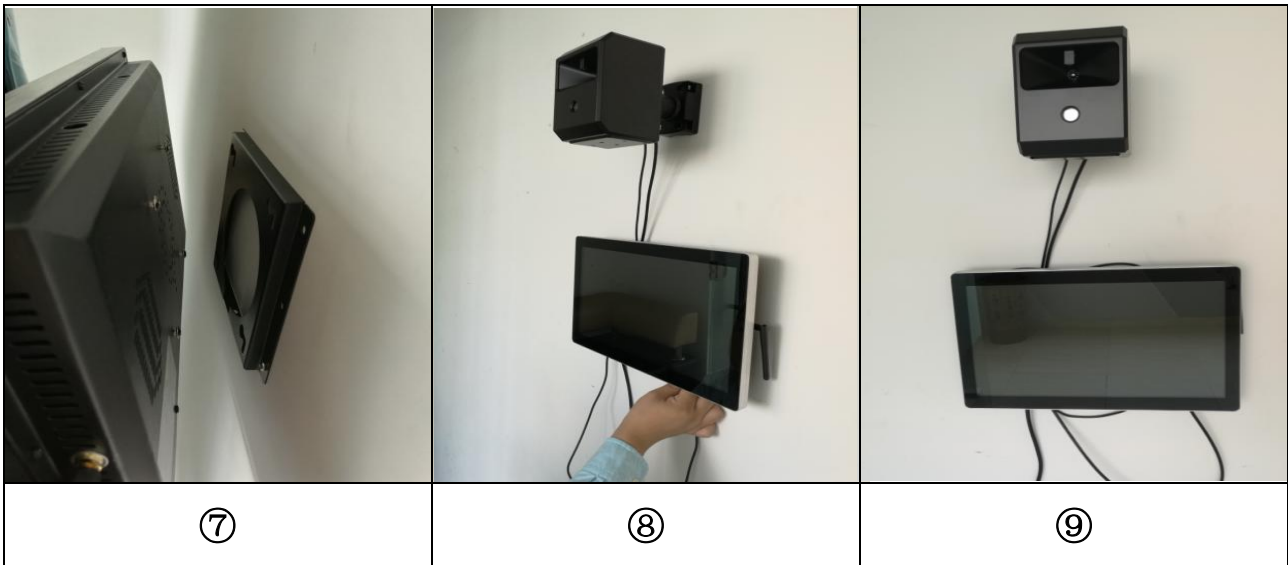

6、UI description

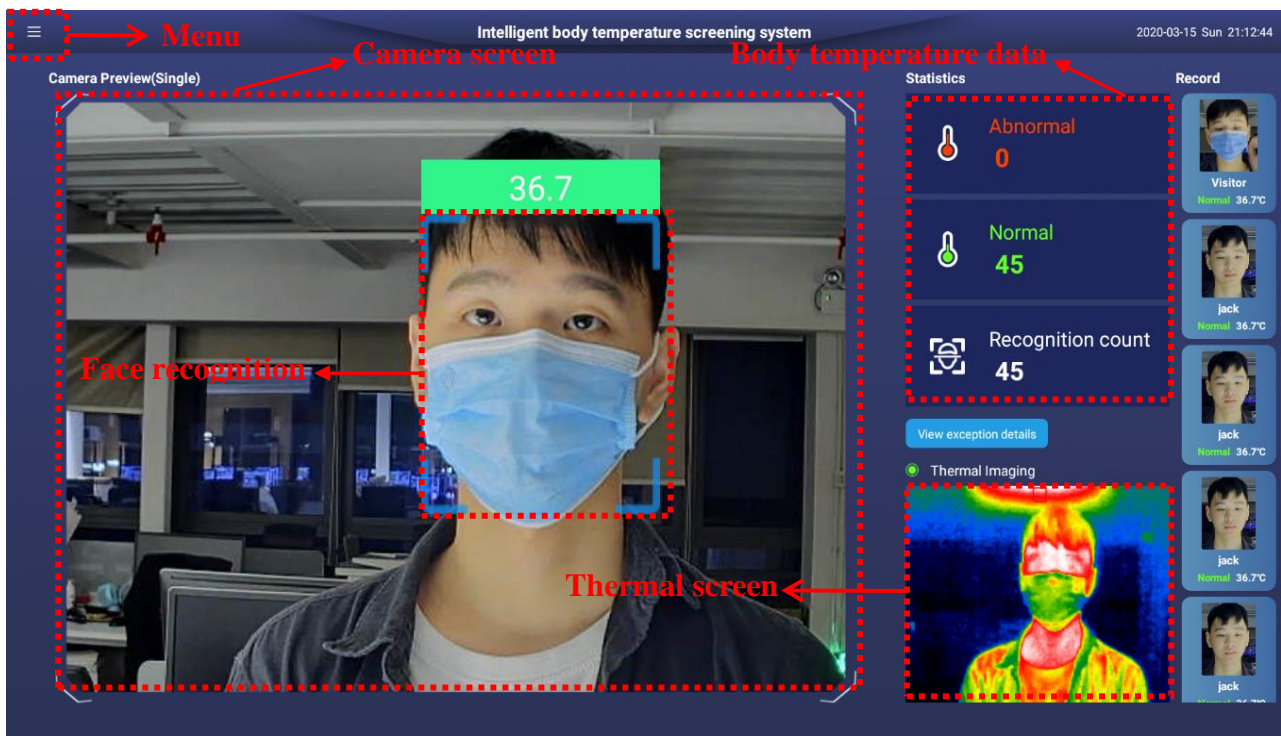

Modules

① statistics: query body temperature records and export data

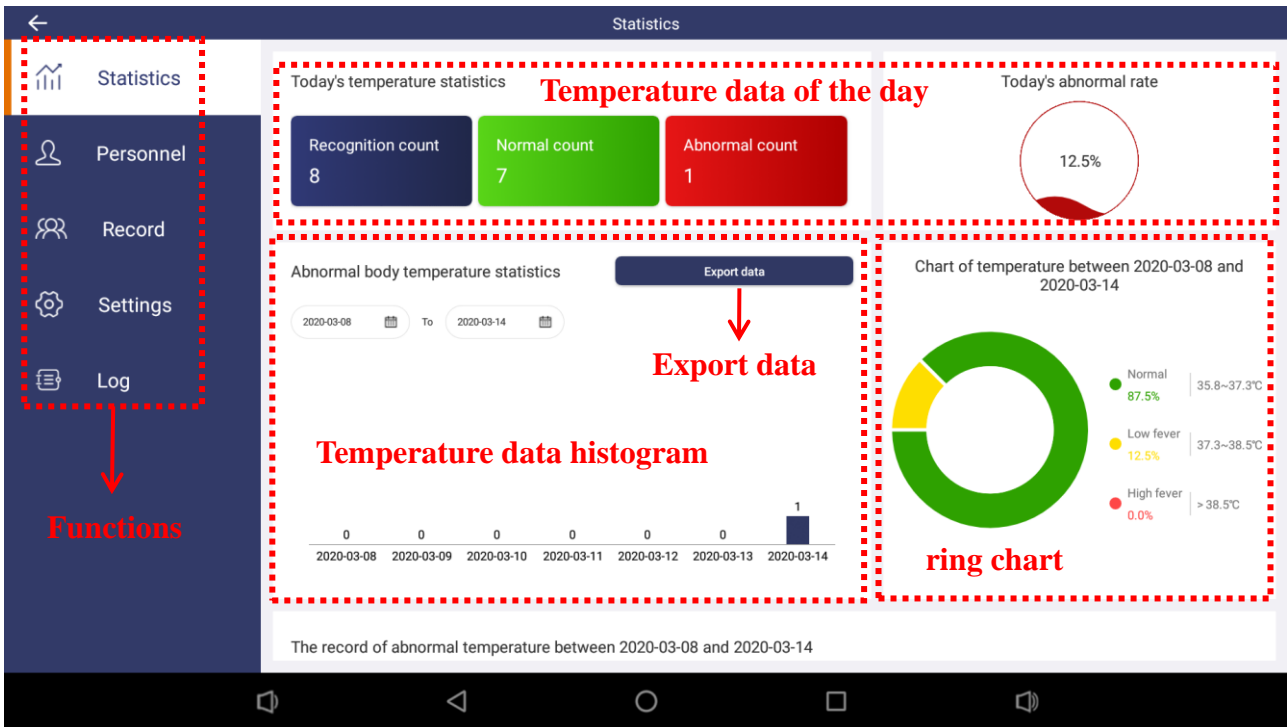

② Personnel : Query, edit and register personnel

1. Enter the name; query the personal temperature measurement record.
2. "x" to add personnel, choose to take pictures (pictures) and batch import.
3. Note: The server version registers personnel through the server.

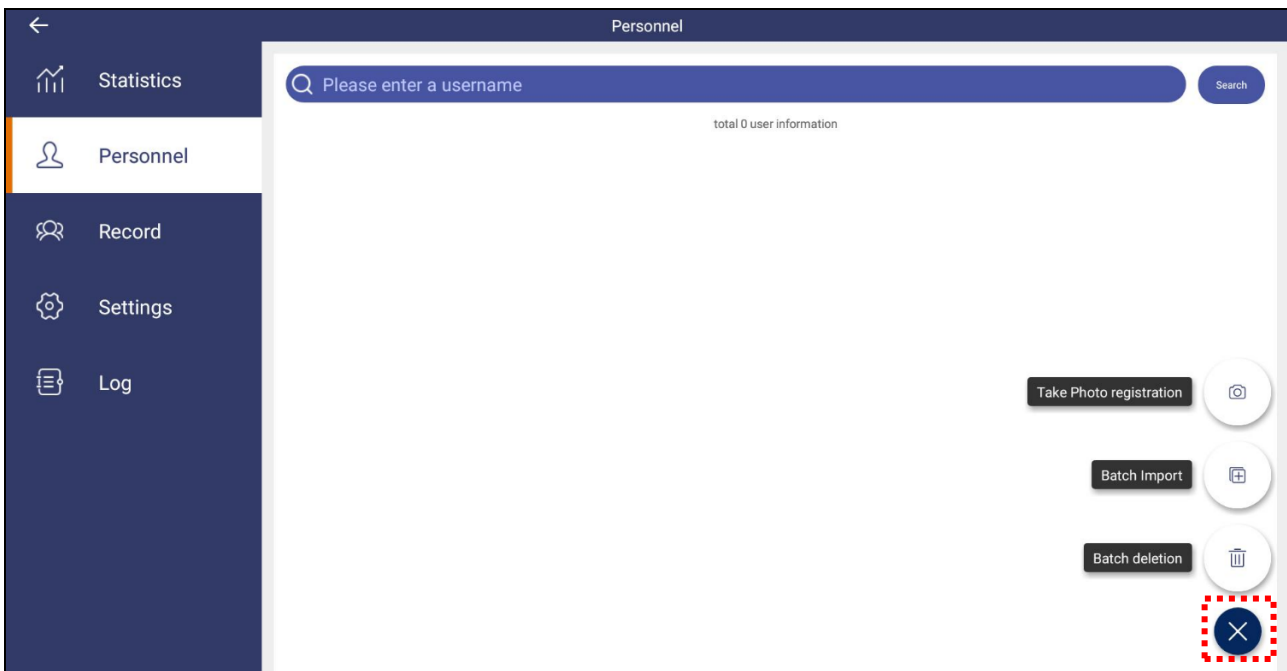

4、 Photo registration



Step 1 : Enter name and number

Step 2 : Photo or picture registration

Step 3 : save

5、 Batch Import

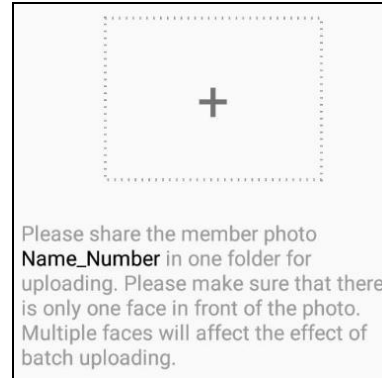

Step 1 : Pictures are named in a folder by name_number

Step 2 : submit after selected folder

③ Record : Select time range to view historical identification records



7、 Setting instructions

- **Recognition mode:** you can choose single or multiple modes.
- **Device information:** You can view the device information and check for update.

- **Online authorization:** The device has been authorized, it shows "authorized".
- **Advance:** If the temperature deviation is too large due to environmental influences, please calibration under the guidance of a technician.
- **Log:** If the system fails, please upload the logs.

8、FAQ

1. What if the temperature measurement is always high?

Answer: Restart, wait for 5 minutes, it will automatic calibration.

2. What if no image is displayed after the program starts?

Answer: Please double-check whether the wiring is correct or restart.

3. What if the temperature cannot be measured?

Answer: Make sure the people are within effective distance and the forehead is not covered.

4. What if abnormal body temperature is detected during proper use?

Answer: Please use medical equipment for remeasurement and confirmation.

9、The circumstances beyond free maintenance

1. Out of warranty period.
2. Damage caused by improper use.
3. The barcode being altered or removed, the product being deliberately damaged.
4. Modify the installation file without authorization.
5. Damage due to unexpected factors or human behavior.
6. Damage due to transportation, loading and unloading.
7. Damage due to force majeure such as earthquake, flood, war, strike, etc.

8. Failure or damage caused by other problems rather than the product itself

10、 Contact us

LinkSprite Technologies, Inc.

1067 S Hover St, Unit E-186

Longmont, CO 80501

USA

Tell: 720-480-9713